

## SELF DRILLING SCREWS

### PRODUCT DESCRIPTION

- All steel self drilling screws for metal profiles
- Precision formed drill points for easy installation
- Zinc plated



### FLAT HEAD - ZINC PLATED



### BUTTON HEAD - ZINC PLATED



### COUNTERSUNK HEAD, WING-DRILLS - ZINC PLATED

### GENERAL APPLICATIONS AND USES

Screws are designed to fasten together metal profiles including:

- Drywall stud
- Drywall track
- MF ceilings

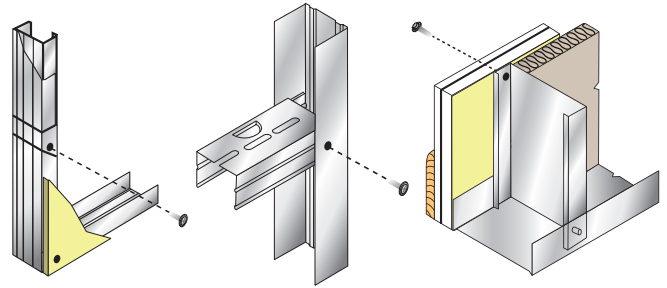

### BASE MATERIAL: METAL TRACK



Cat No.	Description	Profile Size [mm]	Length [mm]	Thread Size [mm]	CE	Box Quantity	Carton Quantity
DWF4020000	SDS Button Head 13mm	0.8-2.5	13	4.2	•	1x1000	8x1000
DWF4020001	SDS Button Head 22mm	0.8-2.5	22	4.8	•	1x1000	4x1000
DWF4020002	SDS Flat Head 19mm	1.0-3.0	19	5.5		1x500	8x500
DWF4020006	SDS Countersunk Wing Drill 38mm	1.2-3.5	38	4.2		1x200	8x200
DWF4020007	SDS Countersunk Wing Drill 45mm	1.2-3.5	45	4.8		1x200	8x200

### COMPLIANCE



### PERFORMANCE DATA AS PER HARMONIZED TECHNICAL SPECIFICATION EN14566

Thickness of tested metal profile	0.6mm
Requirement for tensile resistance	≥450N
Corrosion resistance	Class 24
Reaction to fire	Class A1
Screwing performance	≤1sec

### RECOMENDED LOADS - METAL PROFILE - SDS

Cat No.	Thickness of metal profile [mm]	Thread size [mm]	$N_{rec}$ (kN)
DWF4020000 & DWF4020006	0.6	4.2	0.92
DWF4020001 & DWF4020007	0.6	4.2	1.26
DWF4020002	0.6	5.5	1.26

### MATERIAL SPECIFICATION

	Anchor Body	Finish
SDS Button Head	SAE-1022	Zinc plated
SDS Flat Head	SAE-1018	Zinc plated
SDS Countersunk	SAE-1022	Zinc plated

$$\frac{N_{Rk}}{\gamma_M \cdot \gamma_F} = N_{rec}$$

$\gamma_M = 2.1 \quad \gamma_F = 1.4$

